

2" BORE STAINLESS STEEL CYLINDER



SSR-32-□-□

Single Acting



Mount: Stud **Standard Stroke Lengths:** 1", 2", 3", 4", 5", 6", 7", 8", 10", 12"
Type: Rotating Rod **Spring Compressed:** 30 lbs. **Spring At Rest:** 15 lbs.
Options: M, B, V, S, N, W **Maximum Stroke:** 20" For M option add 0.125
 For S option add 0.375

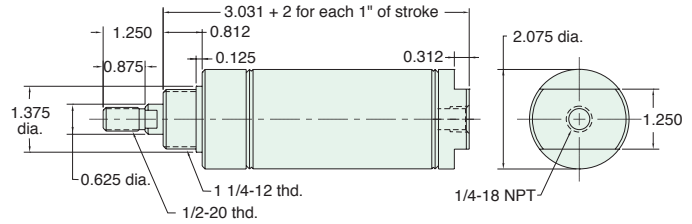

Nut included, but not shown on drawing

USR-32-□-□

Single Acting



Mount: Universal **Standard Stroke Lengths:** 1/2", 1", 1-1/2", 2", 3", 4"
Type: Rotating Rod **Spring Compressed:** 30 lbs. **Spring At Rest:** 15 lbs.
Options: M, B, V, N, P6, W **Maximum Stroke:** 19" For M option add 0.125

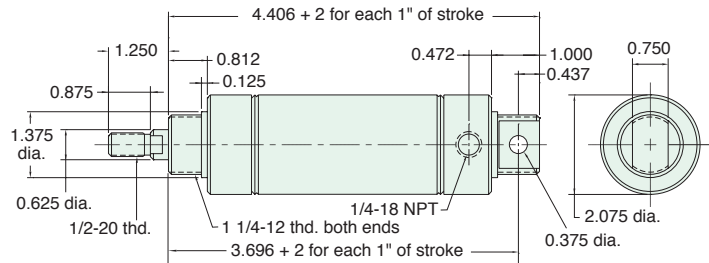

Furnished without nut(s). See Chart on [Page 54](#).

SDR-32-□-□

Double Acting



Mount: Stud **Standard Stroke Lengths:** 1/2", 1", 1-1/2", 2", 3", 4", 5", 6"
Type: Rotating Rod **Maximum Stroke:** 39"
Options: C, F, R, M, B, W, V, P6, P7, P8, S, N For C, F, R and S options add 0.375

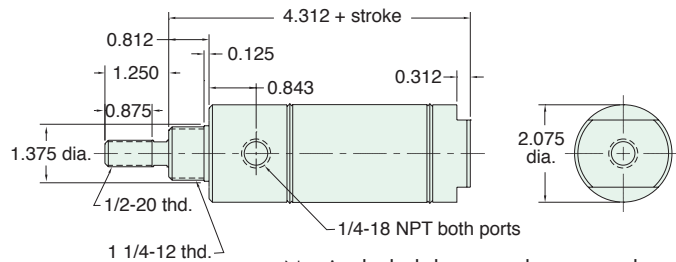

Nut included, but not shown on drawing
 C, F, & R options use side ported rear head

UDR-32-□-□

Double Acting



Mount: Universal **Standard Stroke Lengths:** 1/2", 1", 1-1/2", 2", 3", 4", 5", 6", 7", 8", 10", 12"
Type: Rotating Rod **Maximum Stroke:** 38"
Options: C, F, R, M, B, W, V, P2, P3, P4, P5, P6, P7, P8, N

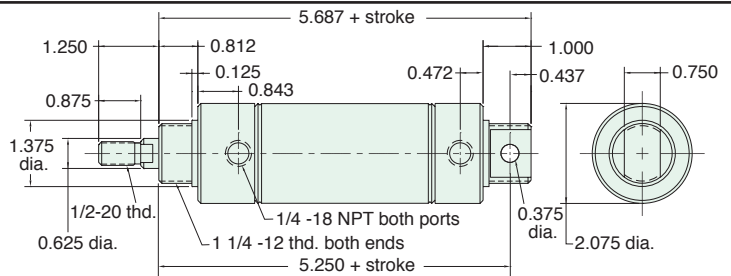

Furnished without nut(s). See Chart on [Page 54](#).